



# LRA-EX1000S Door Chime Extender Kit

## Owner's Manual

This device complies with Part 15 of the FCC rules, Operation of this device is subject to the following conditions: 1. This device may not cause harmful interference. 2. This device must accept any interference, including interference that may cause unde-sired operation.

### Introduction

The LRA-EXTX (transmitter) connects to a standard wired doorbell. When the wired push button outside is pressed, the doorbell dings as usual, and the LRA-EXTX transmitter is triggered and sends a radio signal the receiver is the LRA-DCRXS.

### Important Notes

- The LRA-EXTX chime extender can work with both the front door & "second" door of your wired doorbell.
- The transmitter only works with standard wired doorbells that play a "ding" or "ding-dong" sound. It does not work with intercom or video doorbells.
- The transmitter works 9V-18V AC wired door chimes.
- Powered by a CR123A battery that should last up to 2 years prior to replacement.
- Dimensions are 2-1/4" L x 2-1/4" W x 1/2" D.
- Must be used in conjunction with LRA receivers such as the LRA-DCRXA-L or the LRA-DCRXS-L.

### Installing the Battery in the LRA-EXTX

1. Open the front cover using a small flat-head screw driver (see figure 1).
2. Insert included CR123A battery into the battery compartment (ensure you remove the plastic wrap around the battery prior to installing.)
3. Press the "front door" or "back door" button (see figure 2). You should see a red LED light up to show the transmitter is working correctly.

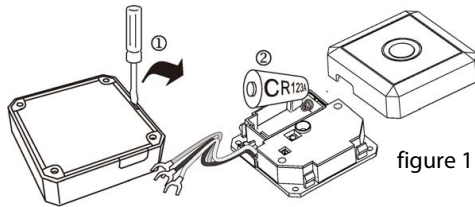

figure 1

### Programming the LRA-EXTX to the LRA-DCRXS

The LRA-EXTX is capable of working with a wired doorbell with two door capability, typically the "front" door and a "second" door on the wired doorbell (these are the wired doorbell push buttons wired to the wired doorbell in your home.)

The LRA-EXTX can send a signal when the front doorbell button is pressed and a signal when the second wired doorbell button is pressed. NOTE: it does not have to be wired for two doorbell buttons.

The receiver featured in this kit is the LRA-DCRXS plugin wireless receiver. Each LRA-DCRXS can work with up to two LRA compatible transmitters/sensors. Because the LRA-EXTX can work with two wired doorbell buttons it may act as one or two transmitters programmed to the LRA-DCRXS receiver.

### Programming the LRA-EXTX to the LRA-DCRXS (cont.)

Plug the LRA-DCRXS into a standard wall outlet. On one side of the receiver you will find a selector switch. This is to switch the operating mode of the receiver to "sound only," "strobe & sound," or "strobe only." On the other side of the receiver you will find two buttons used in programming. The "zone" button, represented by a black dot, and the "melody" button represented by a musical note.

1. Ensure the battery is installed in the LRA-EXTX and the LRA-DCRXS receiver is plugged in.
2. Press & hold the zone selector button • for approximately three seconds until you see a red led flashing on the receiver .
3. When it starts to flash, release the zone selector button. The flashing LED zone signifies that this zone is in programming mode.
4. By default, the LRA-EXTX will play the "ding-dong" sound. If you are okay with this sound, skip this step & go to step 6. Next you will select the desired melody zone by scrolling through the melodies using the melody selector button ♪ (located next to zone selector button).
5. Once you hear the desired melody, stop pressing the melody selector button ♪ .
6. Press the "front door" button on the LRA-EXTX transmitter.
7. You will hear a short tone sound denoting successful programming. The red LED should still be blinking.
8. If you are only programming the front door, go to step 11.
9. If you would like to program the "back door button," scroll through the available melodies by pressing the melody selector button. Once you have found the melody you want for for the back button, stop pressing the button.
10. Next, press the "back door" button on the LRA-EXTX.
11. To exit programming mode press the zone button.

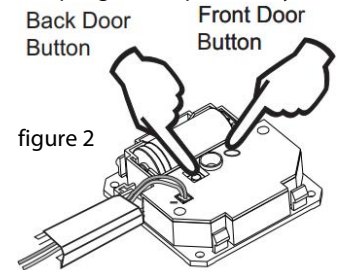

### Changing the Melody on the Receiver AFTER Programming

At a later date, you may decide to change the melody for the front or back buttons. To do this, place the receiver in programming mode by holding down the zone selector button for approximately 3 seconds until you notice a red LED in the strobe light window.

Press & release the melody selector button to find the melody you want. Press the front or back button on the LRA-EXTX you want that melody to correspond to. To exit programming mode, press the zone selector button.

### Erasing the Programming

In the event you need to replace the programming a zone on the receiver, you will need to erase the programming.

Press & hold the zone selector button for approximately three seconds until the red LED displays. Release the button. Next, press & hold the zone selector & melody selector buttons at the same time for approximately 3 seconds. You should hear a tone sound and the red LED will start blinking rapidly. This denotes the memory has been erased & the receiver is ready to be programmed.

## Test the Programming

After completing the programming steps above, test the programming/pairing prior to mounting the transmitter. Push the "front door" button and/or the "back door" button on the transmitter. You should see a red LED on the transmitter & the receiver should flash and/or play the selected melody (see receivers for mode of operation settings). If there's no red LED on the transmitter, ensure the plastic wrapper is removed from the battery & it's inserted correctly.

## Installing/Mounting the LRA-EXTX to Your Doorbell

The transmitter may be small enough to fit inside your wired doorbell cabinet or you may decide to simply set it on top of your wired door chime cabinet.

The instructions below illustrate using the "cable duct." This is not mandatory and is only aesthetic purposes. After wiring the transmitter to your wired doorbell, you can decide the best location to place the transmitter. You can use the double sided tape or mounting screws to mount the transmitter to the wall, hide it in the doorbell cabinet, fix to the side, or simply lay it on top of the doorbell cabinet. **We recommend using the included screws to enable you to easily take it down to change the batteries.**

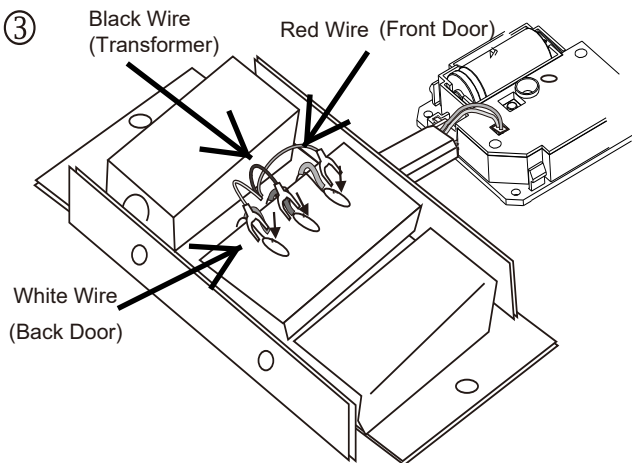
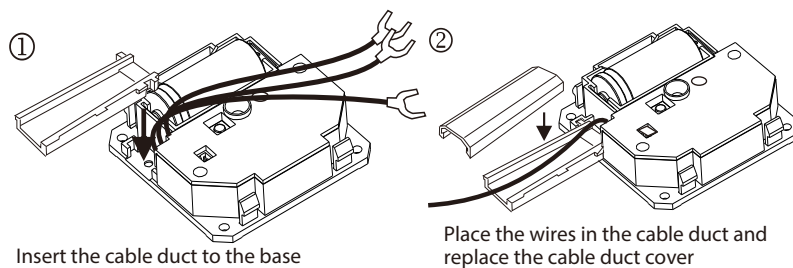

Safeguard Supply | 904-245-1184 | info@safeguardsupply.com

 **WARNING:** Cancer and Reproductive Harm. Go to [www.P65Warnings.ca.gov](http://www.P65Warnings.ca.gov) for more information.

## Wiring the Transmitter to Your Wired Doorbell

*\*If you are not familiar with electrical projects, please hire a certified electrician. Ensure you have no power going to your wired doorbell by turning off the circuit breaker.*

- Connect the red wire from the transmitter to the front door terminal screw on your wired doorbell (see #3 above).
- Connect the black wire from the transmitter to the second or back door terminal screw on your wired doorbell. If you are not using a second door you can go ahead and connect it or wrap the connector of the wire in electrical tape to prevent interference.
- Connect the black wire from the transmitter to the "transformer," or "common" terminal screw on your wired doorbell.
- Test the installation by pressing the outdoor push button. Ensure you have turned the power back on and the receiver is turned on.
- Your wired doorbell should ding as normal & your LRA receiver should respond per its settings.
- Place the transmitter in the desired location & affix it using the double-sided tape or mounting screws.

## Low Battery Indicator

A randomly blinking zone light on the LRA-DCRX receiver (or a red LED in the LRA-DCRXS) indicates that the battery is low for this transmitter. receiver. Please replace the battery as soon as possible.

If the strobe light on the LRA-DCRX seems to randomly flash, it means the batteries in the receiver are weak and needs to be replaced.

## TECHNICAL SUPPORT

If you encounter any difficulty in the operation of this product after reading the manual, please contact us. You can reach us by phone at 904-245-1184 from 8:00 AM to 5:00 PM Monday through Friday (Eastern Standard Time). We will be happy to answer your questions and help you in any way we can.

## WARRANTY

*Safeguard Supply warrants this product to be free of defects in material and workmanship for a period of one year from the date of purchase. This warranty does not cover damage resulting from accident, abuse, act of God or improper operation. If this product does become defective, simply return it to Safeguard Supply. Please include a note describing the troubles along with your name and return address as well as the original sales receipt. If the product is covered under warranty it will be repaired or replaced at no charge. If it is not covered by warranty, you will be notified of any charges before work is done.*

### Safety Instructions

**Warning:** To prevent fire or shock hazard. Do not expose this unit to rain or moisture.

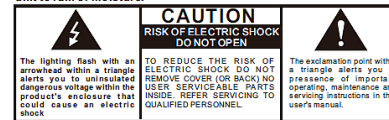

### FCC Statement:

This equipment has been tested and found to comply with the limits for a Class B digital device, pursuant to part 15 of the FCC Rules. These limits are designed to provide reasonable protection against harmful interference in a residential installation. This equipment generates, uses and can radiate radio frequency energy and, if not installed and used in accordance with the instructions, may cause harmful interference to radio communications. However, there is no guarantee that interference will not occur in a particular installation. If this equipment does cause harmful interference to radio or television reception, which can be determined by turning the equipment off and on, the user is encouraged to try to correct the interference by one or more of the following measures:

Reorient or relocate the receiving antenna.  
Increase the separation between the equipment and receiver.  
Connect the equipment to an outlet on a circuit different from that to which the receiver is connected.  
This device complies with part 15 of the FCC rules. Operation is subject to the following two conditions: (1) This device may not cause harmful interference, and (2) this device must accept any interference received, including interference that may cause undesired operation.  
Note: Modifications to this product will void the user's authority to operate this equipment.

